

Zigbee Tubular Motor with Adapter User Manual

01 Product Info

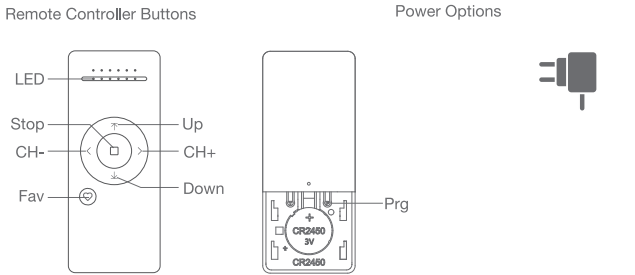
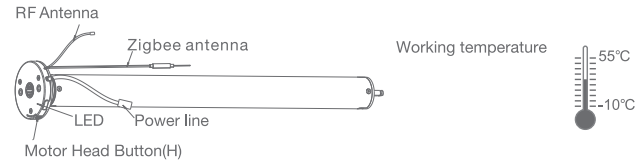

Models & Parameters (for details about other parameters, see the product nameplate)

JCD	25	S	AE	11	30	Z
DC Motor	Tube Diameter: 25 mm	S: Standard Q: Quiet P: Performance	With adapter	Torque: 1.1 N.m	Speed: 30 Rpm	Built-in Zigbee module

02 Caution!



- This product is for indoor use only, do not use outdoor or in humid environments.
- The power supply for this motor is adapter with 12V (Note: Adapter with 8.4V for JCD15SAE).
- The motor will jog in operation, please do not proceed to the next step until it complete.
- During operation, the effective interval of the transmitter button operation is 10 seconds. If there is no effective transmitter operation for more than 10 seconds, it will automatically exit the current mode.
- The motor can be paired with max 10 controllers.
- Upper&Lower limits cannot be set at the same position, limits saved even power off.
- The motor runs constantly for 6 mins max without any other operation.
- Do not lift the motor by grabbing the wire or antenna.

03 Instructions

Motor head button (H) functions

Functions	Operation	Jogging time	LED lamp flickers	Note
Control the UP/STOP/DOWN of the shade	Short press	/	/	Can only operate after limits are set
Adding/Removing Controller	Hold for 2s	Jog*1	Flicker*1	Operation needs be done within 10s
Zigbee Connecting	Hold for 6s	Jog*2	Flicker*2	Entering Zigbee connection mode
Direction Reverse	Hold for 10s	Jog*3	Flicker*3	All settings saved after direction reversed
Reset	Hold for 16s	Jog*4	Flicker*4	All settings deleted

a. Pairing Motor with Controller

Way 1: Before adding a new controller

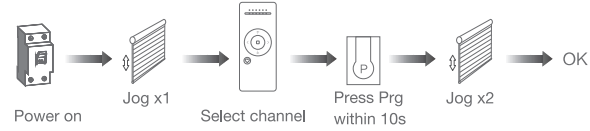

Way 2: After motor is powered on for more than 10s

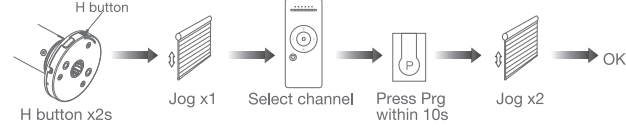

Way 3: Power on, add controller B via pre-existing controller A

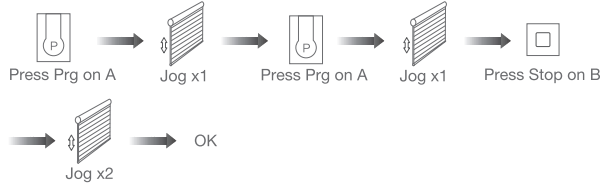

Note: Pairing can not be done under group channel or 0 channel.

b. Direction Reverse



If the limits are not set, and direction goes opposite.

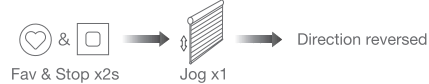

If limits are set and direction goes opposite.



Note: Do reverse the direction when it goes opposite.

c. Upper&Lower Limits Setting

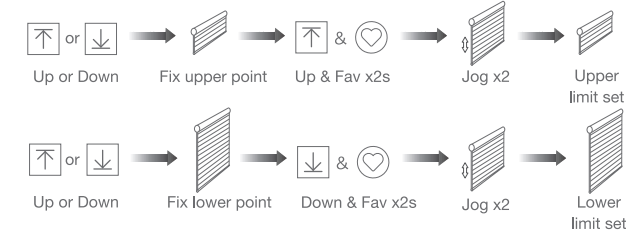

Note: Upper&Lower limits cannot be set at the same point. Before limits set, the motor will run in one-touch mode by pressing Up or Down, hold Up or Down for 2s, motor runs in constant-touch mode. Once limits set, press Up or Down, motor runs in constant-touch mode.

d. One-touch/Constant-touch Mode

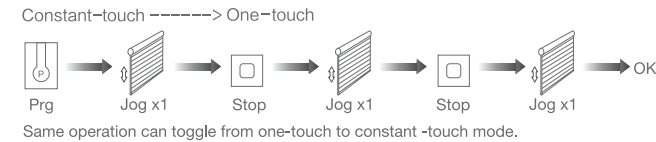

Same operation can toggle from one-touch to constant -touch mode. Note: When motor in one-touch mode, hold Up or Down for more than 2s, it will run in constant-touch mode.

e. Setting and Cancelling Favorite Position



f. Hot key to the Fav. Position

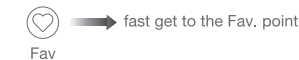

Note: The Fav. position setting only can be done after upper&lower limits set.

g. Adjusting Upper & Lower Limits

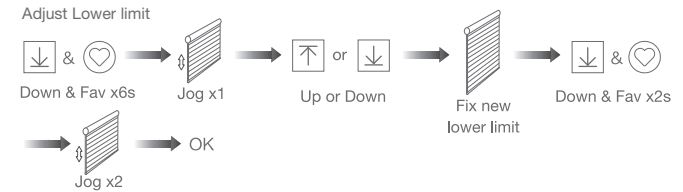
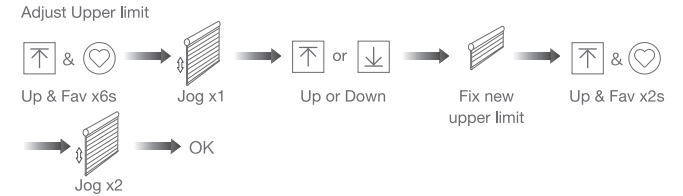

Note: The operation should be done within 4mins.

h. Adjusting Motor Speed

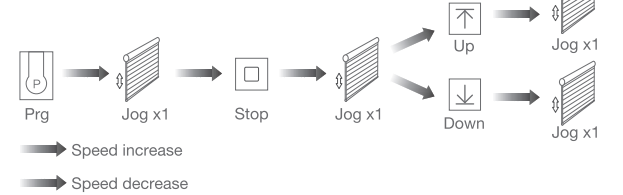

Note: If motor doesn't jog, the max/min speed has already been reached. There are 3 speeds adjustable.

i. Removing Controllers

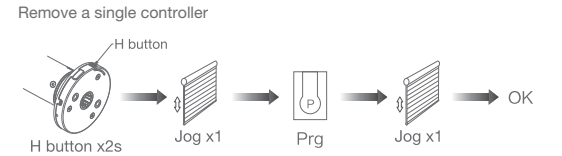

Remove controller B via pre-existing controller A

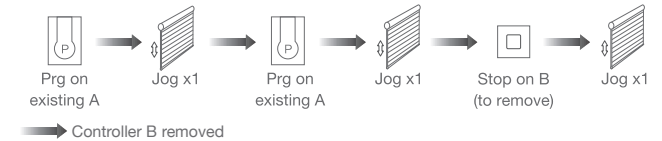

Remove all controllers:

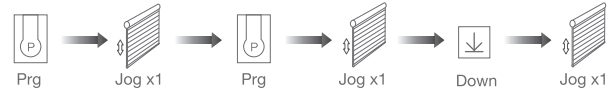

➡ All controllers removed

Note: All the settings are saved even controllers removed (limits set are saved).
Controller A/B are already paired to motor.

j. Cancelling Limits

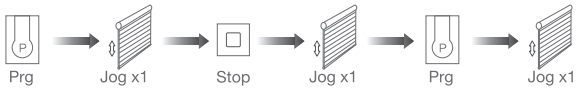

➡ Limits cancelled

Note: It is forbidden to run the motor if installed into the shade without limits.
Limits should be set immediately to protect the shade.

04 Zigbee Connecting

*Connection requirement

- Make sure the phone is connected to the Wi-Fi network.
- The Tuya Zigbee gateway device need to be added to the "Smart Life" APP first, please refer to its manual for details.

① Download APP

- Search for "Smart Life" in the app store or scan the QR code
- Complete account registration and login to the app



② Add Device

- Make sure the phone is connected to the Wi-Fi network
- Make sure the Tuya Zigbee gateway device is connected to "Smart Life" App
- Make the motor is ready to be connected to Zigbee by following steps:

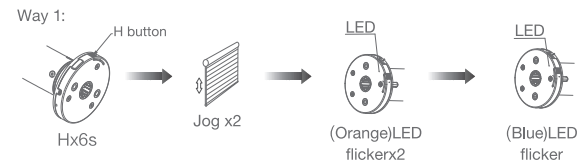

➡ Zigbee connecting

Way 2:

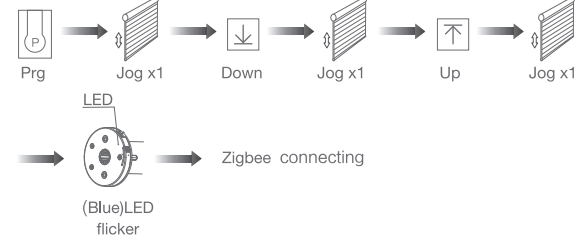

d. Find the added Tuya Zigbee gateway on the "Smart Life" App, click "+" to add a sub-device, and then click "LED already blink", the APP will automatically search for motor device

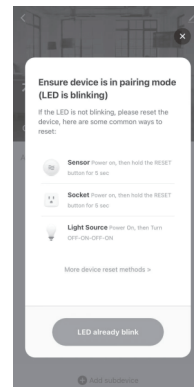
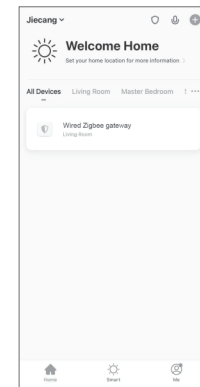

e. After adding successfully, click "✎" to modify the device name

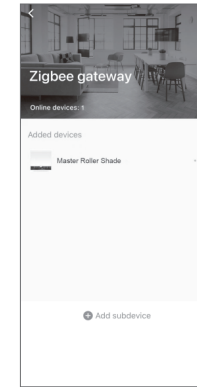
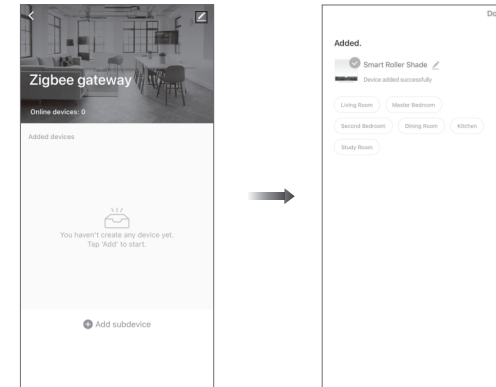

f. After the motor device is added successfully, the LED on motor head will be on for 10s and then go off.



g. Now the motor can be controlled by App from anywhere, anytime

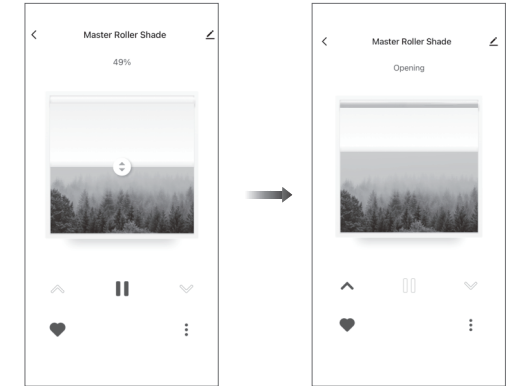

05 Troubleshooting

Fault	Cause	Solution
Motor does not work	1. Controller not paired 2. Motor inactive	1. Add controller 2. Hold H button for 2s to activate motor
Motor stops suddenly	1. Upper & Lower limit set incorrectly 2. Shade exceed rated load	1. Re-set Upper & Lower limits 2. Adjust load
Motor just goes in one direction	Wrong limits set	Cancel original limits, set new limits